

CASEMENT

Thermally broken

Thermally broken window that allows for both side hung and top hung outward openings. This solution, with a thermal break zone of 32 mm and a transmittance U_w from 1,0 W/m^2K , has the British security certification PAS 24, being especially suitable for this market.

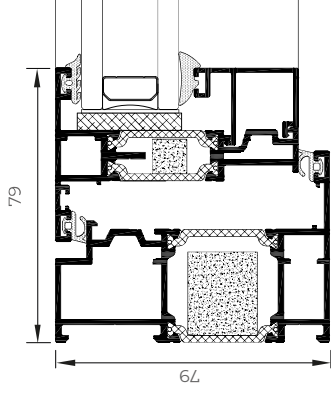

* Flush Version

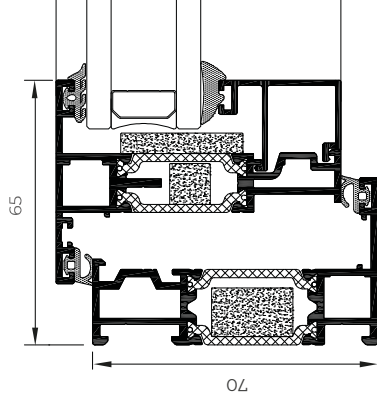

* Standard Version



Sightlines

Frame 70 mm, Sash 70 mm

Polyamide Strip Length

32 mm

Profile Thickness

Window 1,6 mm

Glazing

Max. 44 mm, Min. 23 mm

Maximum Sash Dimensions

Slim Sash (Side Hung):

Width (L) 700 mm, Height (H) 1300 mm

Slim Sash (Top Hung):

Width (L) 1200 mm, Height (H) 1300 mm

Heavy Duty Sash (Side Hung):

Width (L) 750 mm, Height (H) 1750 mm

Heavy Duty Sash (Top Hung):

Width (L) 1800 mm, Height (H) 1800 mm

Maximum Sash Weight

Side Hung Slim Sash: 35 kg







Top Hung Slim Sash: 50 kg

Side Hung Heavy Duty Sash: 42 kg

Top Hung Heavy Duty Sash: 100 kg

Consult maximum weight and dimensions according to typologies

FEATURES

Transmittance	 $U_w \geq 1,0 (W/m^2K)$
Acoustic insulation	 R_w up to 45 dB
Air permeability	 Class 4
Water tightness	 Class E1200
Wind resistance	 Class CE 2400
Security test	 PAS24 <input checked="" type="checkbox"/> Passed

Reference test: 1,438 x 1,355 m / 1 sash + 1 fixed light

Security test: Reference test: 1,438 x 1,355 m / 1 sash + 1 fixed light

POSSIBILITIES



SECURITY
HARDWARE



CONCEALED
HINGES

OPENING POSSIBILITIES



Outward Opening
Side hung
Top hung





CASEMENT